

| REVISIONS | | |
|-----------|-------------|------|
| NO. | DESCRIPTION | DATE |
| | | |

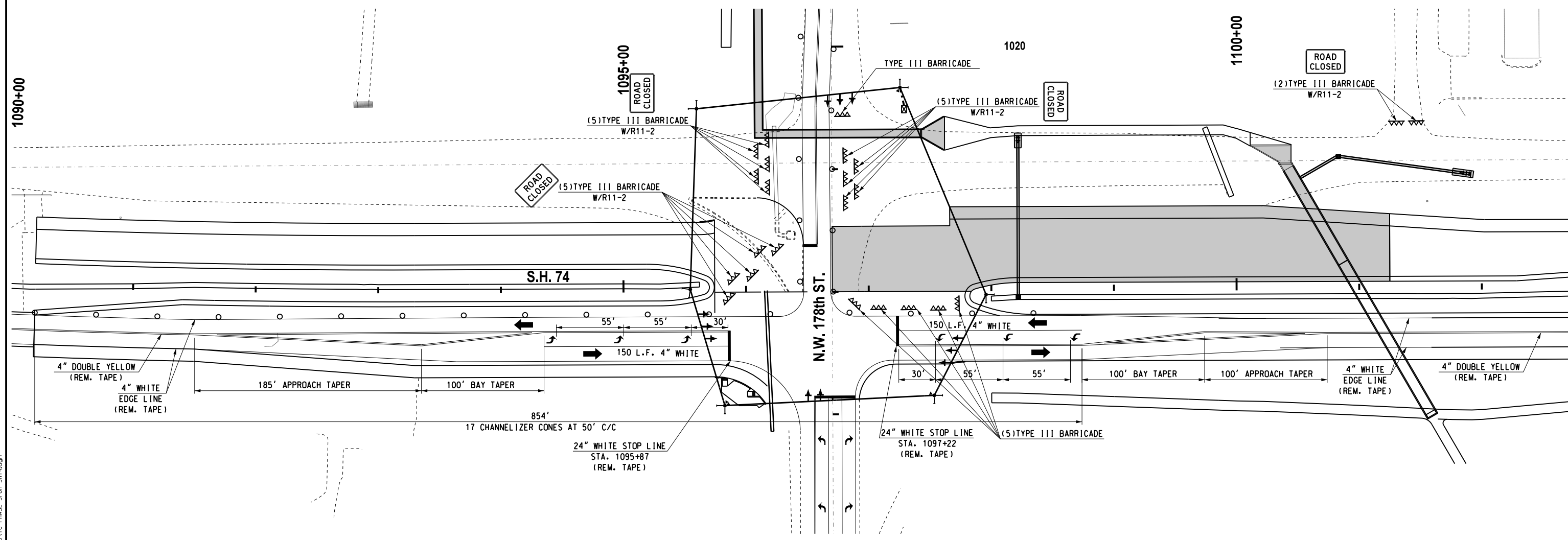
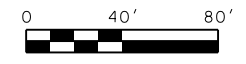

**FOR MORE INFORMATION
ON S.H. 74 SEE PHASE 2M**

**CONTRACTOR SHALL KEEP
11' MINIMUM LANES UNLESS
OTHERWISE NOTED.**

**ALL PAVEMENT MARKINGS
SHALL BE REMOVABLE
TAPE**

**CONTRACTOR TO PROVIDE
ACCESS TO ALL DRIVEWAYS
DURING CONSTRUCTION.**

| LEGEND | |
|--------|---|
| | - TYPE III BARRICADE W/ TWO TYPE "A" LIGHTS |
| | - DRUM |
| | - CHANNELIZER CONE |
| | - PORTABLE CONC. BARRIER WALL |
| | - CONSTRUCTION ZONE IMPACT ATTENUATOR |
| | - WORK AREA |

| | | |
|--------|-----|----------|
| Design | RWR | 08/10/17 |
| Drawn | GDB | 08/10/17 |



**TRAFFIC CONTROL
PHASES 3F, G & H
S.H. 74**

State Job No. 14964(08) Sheet No. T63

08/10/17 G:\Projects\T-16628 SH 74 @ NW 178th, NW 192nd & NW 206th\CAD\TC PHASE 3FGH SH74.dgn